

# Order form

**ORDER** e: [roofsales@ultraframe.co.uk](mailto:roofsales@ultraframe.co.uk)

**QUOTE** e: [quotes@ultraframe.co.uk](mailto:quotes@ultraframe.co.uk)

# Glassroof

By Ultraframe

## ACCOUNT No

Company Name

Order Number

## JOB REFERENCE

Installer Company Name

Company Contact

Telephone No

Email

Delivery Address

## PLAN VIEW

## FRONT ELEVATION

### POSTCODE

Delivery Date Req

Quotation Ref

### CRITICAL INFORMATION

\*Required for structural snow / wind loading

\*Site Postcode

Roof Pitch (°)

Roof height restriction

Frame width

## How to place an order for a Glass Roof

## LEFT ELEVATION

## RIGHT ELEVATION

1. Fill in above information and sketch plan and elevations showing position and dimensions of walls, brick piers, windows, doors, cut outs and intrusions. If necessary, attach photos of existing property.

2. Advise of the preferred position of any roof vents, rainwater pipes (RWP), tie bars and any additional information that may assist in specifying your order. If a Goalpost is needed, please complete page 3 of this order form.

3. A confirmation drawing will be created using our bespoke software and sent to you via email for you to check and sign. This will start the manufacture process. A delivery date will be emailed back as soon as it is scheduled.

In order to pass building regulations, all conservatory over 2.5m wide will need a glass U-value of at least 1.2. Smaller conservatories will need glass to be specified with 1.0 U-value. The thermal design guide within UDesign will provide the specific U-Value of each glass roof.

Ultraframe are committed to not only offering the very best products but the best Customer Service experience. If you have any questions, queries or concerns please feel free to contact us on **01200 452 904** or email us on [roofsales@ultraframe.co.uk](mailto:roofsales@ultraframe.co.uk) and we will help any way we can.

If you have a technical question relating to our products, please contact our technical team on **01200 452 918** or email us on [techsupport@ultraframe.co.uk](mailto:techsupport@ultraframe.co.uk).

You can also find technical help or any of our product literature on our website <https://trade.ultraframe-conservatories.co.uk/trade/media>

# Order form

# Glassroof

By Ultraframe

## JOB REFERENCE

ROOF COLOUR	White	Deeplas	Grained Grey	Smooth Grey	Mahogany	Light Oak	Rosewood	Black	Bespoke RAL/BS Colour
External	<input type="checkbox"/>	<input type="checkbox"/>	<input type="checkbox"/>	<input type="checkbox"/>	<input type="checkbox"/>	<input type="checkbox"/>	<input type="checkbox"/>		
Internal	<input type="checkbox"/>	<input type="checkbox"/>	<input type="checkbox"/>	<input type="checkbox"/>	<input type="checkbox"/>	<input type="checkbox"/>	<input type="checkbox"/>		

## INTERNAL PELMET (when internal pelmet specified)

☐ 300mm ☐ Other (300-1200mm)

Please State (mm):

☐ On Fascia ☐ Below Fascia

If fitting to a bungalow please indicate Soffit Depth .....

## CORNICE

Style ☐ 1 Tier ☐ 2 Tier ☐ 3 Tier ☐ Curved  
Colour ☐ White ☐ Matt Grey ☐ Deeplas ☐ RAL/BS Colour .....

## RIDGE

☐ Classic Ridge  
☐ Slimline Ridge (ONLY on 25° georgian roof)

## TOP CAPPINGS

☐ Dome (PVCu) Aluminium  
☐ Bevel (PVCu) Square Aluminium  
(Mono pitch lean-tos only in grey or white)

## STRUCTURAL SUPPORT

☐ Structural (SEB) Eaves Bolstered Eaves Goalpost

Show openings on roof drawings on page 1.  
Please refer to page 1 of the order form and complete elevation drawings if there are openings over 1800mm.

If Goalpost required- complete page 3

## DOWNPIPE

☐ Round  
☐ Square

## CONSERVAFLASH

☐ Yes  
Eaves flow (eaves beam trickle ventilation)

## BOX GUTTER OPTIONS:

☐ 165mm 165mm Chambered  
☐ 265mm Reinforced Box Gutter  
Other, please state:

## GLASS OPTIONS - WARM EDGE SPACER

### Super Energy Saving Glass

Low Solar Gain	Medium Solar Gain	High Solar Gain
<input type="checkbox"/> Ultimate Blue Aqua 4S	<input type="checkbox"/> Bronze 4S Blue 4S Neutral 4S	Clear 4S

### Good Thermal Efficiency

Low Solar Gain	Medium Solar Gain	High Solar Gain
<input type="checkbox"/> Std Aqua	<input type="checkbox"/> Std Bronze Std Blue Std Neutral	Std Clear

## POLYCARBONATE

Size ☐ 25mm 35mm  
Colour ☐ Clear Opal ☐ Bronze Bronze / Opal Heatguard / Opal

## UNGLAZED

Polycarb ☐ 25mm ☐ 35mm  
Glass ☐ 24mm

## ROTABOND SEALANT - MS POLYMER

☐ Black Tubes (NCGS001B)

## ROOF VENTS AND MECHANISM (mark plan)

Roof vent up to ridge Roof vent with glass above

Brass ☐ Manual Spindle Manual Spindle and pole ☐ Manual Spindle and telescopic pole  
Chrome ☐ Manual Spindle Manual Spindle and pole

☐ Electric motor with digital thermostat and rain sensor ☐ Electric motor and rocker switch  
☐ Electric motor with radio and remote control ☐ Electric motor with thermostat (AVTD002)  
☐ Electric without switch/thermostat (Motor only)

## DECORATION

Cresting	Renaissance	Tudor	Elizabethan	Baroque	Classic	Low profile	Aluminium
Finial	Pikestaff	Sceptre	Ball	Coronet	Classic	Low profile	Aluminium

## ANCILLARY EXTRAS

Please refer to the Classic Technical Guide.

# Goalpost specification

# Glassroof

By Ultraframe

## Goalpost Colour

To match roof internals

Bespoke:- RAL colour

## Leg length

Frame height

Length below floor/cill

## Goalpost leg example

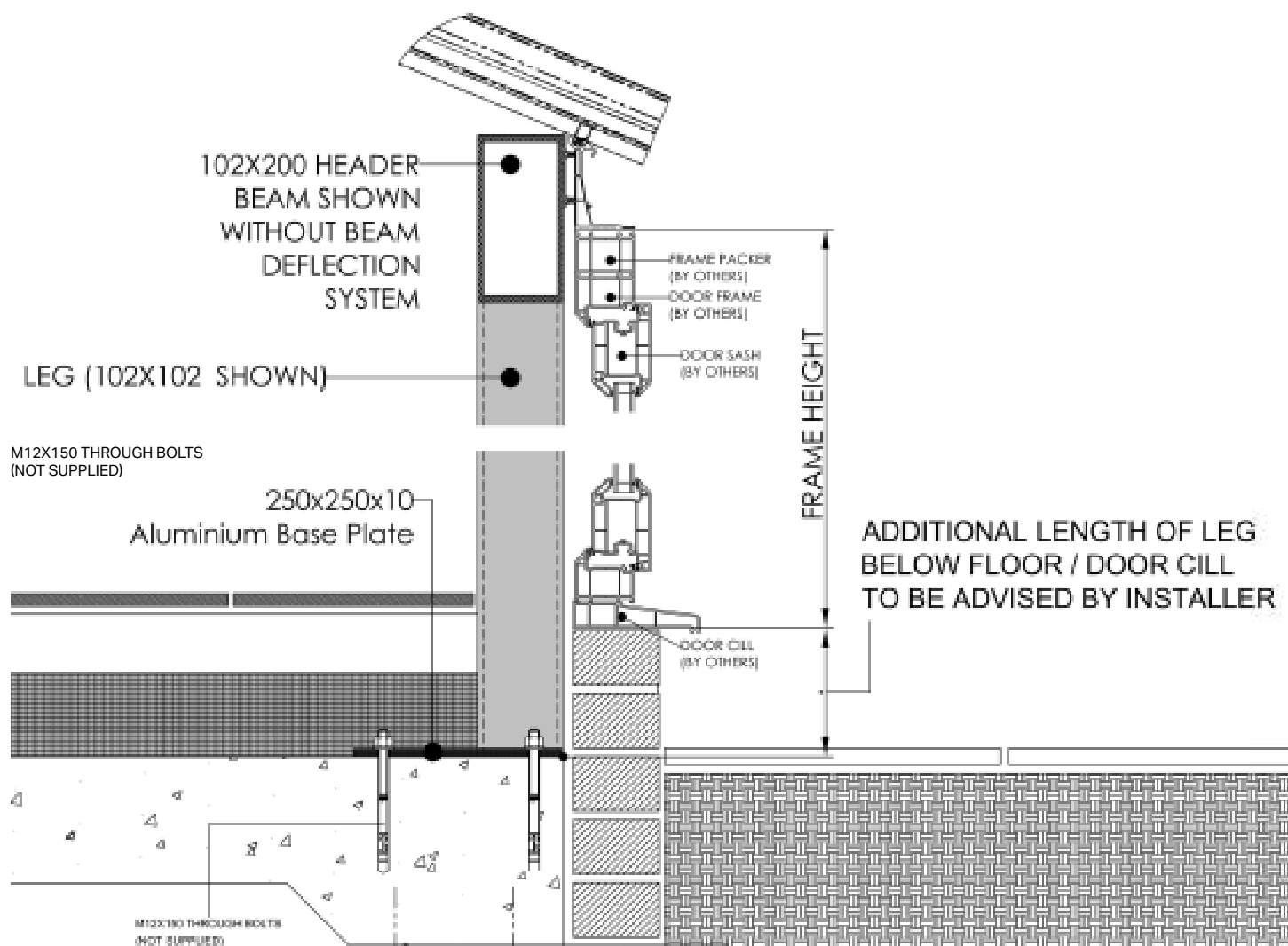

## Disclaimer:

Ultraframe does not take responsibility for the structural stability of the entire structure, only the products provided by Ultraframe. To ensure the rest of the structure is suitable, it is the installers responsibility to ensure that all walls, foundations and building structure are compliant with Document A of Building Regulations. Any adjoining window frames must be a minimum of 70mm reinforced PVC frames, coupled in accordance with the manufacturer's recommendations. Host walls must be suitable to take the additional load and forces of the new building.

All beam end plates (WP and SP) must be bolted to a suitable substrate with adequate anchors. For the WP, the host wall suitability to accept the increased forces must be checked. The SP should be positioned on a suitable concrete padstone built into the supporting wall and strapped down to at least two additional courses.

Baseplates must be anchored using a minimum of 3no. M12 through bolts (minimum 6kN Tension/Uplift capacity per bolt). Foundations or floor slabs must be designed to accept the additional forces.

# Order Form

## 1. Base

Are you using the hup! Base?      Yes      No

**If yes, please answer the questions below:**

What height is the base DPC to ground? .....

Which foundations will you be using?      Pads      Ground screws

If using ground screw, please indicate the name of your ground screw provider.      GBGS      Other supplier .....

Which skirt finish do you require?      Plain      Brick slips (brick type)

If you have a sloping skirt, please draw it on the diagram, giving a measurement every metre.

If you would like brick slips, please let us know the brick type and mortar colour.

Brick type	Red Multi	Smooth Anthracite	Smooth Red	Rustic Buff Multi
------------	-----------	-------------------	------------	-------------------

Mortar colour	Grey	Sand	Red
---------------	------	------	-----

Intrusions needed (please mark on the base plan below)	Drain cover	Obstruction	Drain Pipes
--	-------------	-------------	-------------

Please draw the footprint of your building marking each elevation A, B, C, D etc. Tick the box to indicate which dimension you are using

Existing base size

### Finished wall size

hup! base size (to edge of hup! clips)

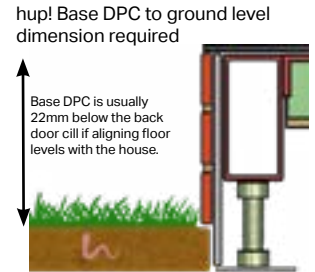

## hup! on existing wall

Is hup! going on a existing wall?      Yes      No

What is the thickness of existing wall? ..... mm

**Do you want it on cill or full clad?**      Cill (use internal frame dimension)      Full Clad (use external base dimension)

If on cill, please send over **ONLY** the internal frame dimension. If using full clad, please send over **ONLY** the external base dimensions.

A full-page sheet of graph paper featuring a uniform grid of thin, light gray lines. The grid consists of small squares covering the entire area, providing a template for drawing or writing.

### Extended Base Tray required?

Width of Cavity wall 300mm. See hup! Specification Guide for more details.

Please note hup! walls will protrude at least 45mm (25mm for battens, plus c15mm depending on claddings) outside of your base so that the wall finishes (claddings) will be ventilated. All critical dimensions will be confirmed before order stage.

Please return to [quotes@ultraframe.co.uk](mailto:quotes@ultraframe.co.uk)

# Order Form



## 2. Elevations

Please draw each elevation of your hup! walls marking the elevations clearly with A, B, C, D etc. Include window and doors sizes and distance from the eaves as well as the floor clearly.

Tick this box if you require the cable management panel which is supplied on all panels above 560mm.

# Order Form

### 3. Wall Finishes

The type of wall finish can change the sequence of the battens and calcium silicate board, please tick the wall finish for this project?

## Brick Slips

Steel façade (Boundary only)

Render

External Cladding - Type .....

#### 4. Walling kit

Please tick the box to confirm which elements of the walling kit you will require to be supplied by Ultraframe.

None - I am supplying my own

Ventilation trim only

Aperture trim only

Batten kit (includes battens and fixings)

Render Board kit (includes ventilation trim, aperture trims and battens)

Brick Slip Rails (includes trims, battens and render Board. Brick slips not supplied)

## 5. Aperture Trim Colour

White

Smooth Grey

Light Oak

Rosewood

### Surveyor's Details

If you would like us to liaise with your surveyor on this hup! order, please put contact details below.

NAME:

CONTACT NO:

EMAIL ADDRESS: